

Bar stools on two sides of the island are useful when friends are visiting or so Jane and Ian can sit facing each other when it is just the two of them.



## PROJECT PROFILE

**Owners** Jane and Ian Atkins live here with their cocker spaniel, Purdey

**House** A two-storey early 18th-century cottage

**Project** An extension and new kitchen

**Kitchen size** 5x5.5m

**Designers** Keith Myers and Amanda Smith, The Myers Touch

**Cabinetry** Bespoke Lincoln in-frame kitchen in Dulux Timeless and island in Farrow & Ball Elephant's Breath

# When wishes COME TRUE

SOFT NEUTRALS AND NATURAL MATERIALS COMBINE TO CREATE INVITING WARMTH IN JANE AND IAN ATKINS' NEWLY EXTENDED AND RENOVATED KITCHEN





The Aga has three cast-iron ovens, slow-cooking and warming ovens, a warming plate and two independently controlled hotplates



Gentle tones and warm oak touches create a tranquil kitchen with welcoming character



The wet zone features work surfaces on both sides, with chopping boards below



The curved wall unit softens the feel, and mirrors the coffee station, diagonally opposite

Many of us have spent more time at home in recent months, forcing a reassessment of how our homes work for us – or don't. But for Ian and Jane Atkins, there was a different impulse for their kitchen redesign. 'It was my retirement that did it,' recalls Ian. 'We were both here full time, and constantly bumping into each other because the kitchen was so small – barely big enough to swing a cat.' After 18 years of living in their cottage, they decided it was time for action and to start work on the kitchen extension they'd been meaning to do for ages.

'The existing kitchen was a strange, impractical shape and we also wanted more space for entertaining, with somewhere to sit when friends pop round for a cup of coffee or a glass of wine,' says Jane. Their solution was to extend the kitchen by about two metres across the front of the house, which also made space for a larger utility room.

At the same time, they had the wall between the kitchen and dining room demolished, to improve the

connection between the adjacent spaces. Following up a recommendation from their architect, Chris Lelliott of MVL, they settled on The Myers Touch to design the new kitchen. 'We love the way the design looks good but is practical too – so much more work space, more storage and a more functional layout, so that it feels much larger,' says Jane. She chose classic in-frame cabinetry to suit the age of the cottage. 'The colours are soft and calm to accentuate the spacious feel, with the milk of the chimney breast and pinky-grey of the splashback to add warmth,' she notes.

Replacing an old Aga with a new, more energy efficient model was key to the success of the project, allowing for better heat management in summer since the hot plates can be turned off. It is next to the square-shaped central island, designed to be in proportion to the scale of the room with a clear walkway around all four sides. 'The project has made a huge difference and we just about live in the kitchen now,' says Ian. 'I wish we had done it years ago.'

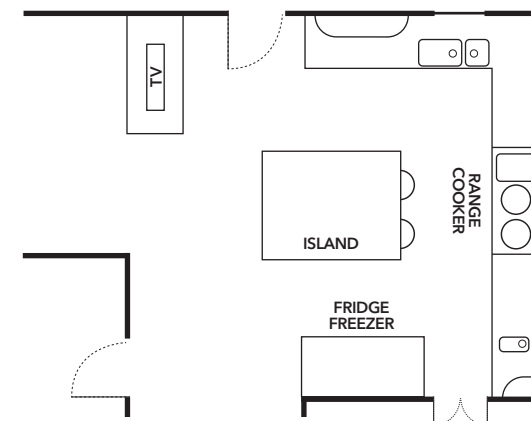

## THE LAYOUT

The newly-enlarged square-shaped space has a central island as the sociable hub of the room, which also provides the main preparation surface. A large Aga makes the focal point of the cooking area, with zones around the room for washing up, making coffee and storing dry and chilled foods. A peninsula zones the kitchen and dining areas, makes a serving station and conceals a pop-up TV.





Cup handles and knobs have a pewter-coloured finish to complement the Aga

## 1 FALSE CHIMNEY BREAST

Built on to the new wall that forms the extension at the front of the house, the Aga cooker has been centrally positioned, balanced by windows on both sides. To accentuate its presence and highlight its role as the focal point of the room, it is built into a false chimney breast. This also conceals the built-in extractor, while its custom-made rustic oak mantel, built by Chalmers Property Care, adds character to the room, as do the soft pink-grey splashback tiles.

## WHEN WISHES COME TRUE

# 3 CLEVER DESIGN SOLUTIONS

## 2 COFFEE CORNER

To create an area for making coffee out of the way of the main cooking and preparation zones of the kitchen, one corner has been dedicated to the task. A custom-made curved wall unit has oak slots for storing coffee pods in easy reach of the machine below, with a shelf above for mugs. A second, small sink fits into the adjacent worktop, complete with an all-in-one tap to dispense 'regular' hot and cold, as well as boiling, chilled filtered and sparkling water, so it is also easy to make tea and all kinds of cool drinks from one spot.

## 3 TV PENINSULA

Inspired by a TV on their boat which lifted out of the work surface to save space, Jane and Ian requested a similar design for their kitchen. They chose not to have a wall-hung screen, since they felt this would be too obtrusive. The Myers Touch created a bespoke slot in the peninsula top to hide the TV screen, which lifts up on a special mechanism when required. The screen can be rotated by 180 degrees to be seen from both the island and the dining area.



To enhance the enjoyment of making a cup of coffee, the coffee station is a custom design



The TV screen lifts up from the peninsula and can be swivelled around to view

## THE DETAILS

### CABINETRY

Bespoke Lincoln in-frame **kitchen** in Dulux Timeless and **island** in Farrow & Ball Elephant's Breath, kitchens from £35,000, The Myers Touch

### SURFACES

Pearl Jasmine quartz surface **worktops**, from £450sq m, Silestone. Bespoke solid oak island and peninsula **worktops**, The Myers Touch. Pergaminho Vintage **limestone**, £102sq m, Panoramics. Artisan Gloss Pink **splashback tiles**, £69.60sq m, Topps Tiles. **Walls** painted in Skimming Stone, £52 for 2.5ltr, Farrow & Ball. **Chimney breast** painted in Grey Oak, £42 for 2.5ltr, Neptune

### APPLIANCES

R7 150 **range cooker**, £14,515, Aga. Gruppo Incasso built-in **extractor hood**, from £446, Falmec. RS90A2 integrated French door **fridge-freezer**, £3,985, Fisher & Paykel. WI6160 integrated **wine cooler**, £1,460, Caple. Custom **TV solution**, Future Automation

### SINKS & TAPS

Phoenician sink **mixer tap**, £560, Perrin & Rowe. Edgworth fireclay **sink**, £1,088, Shaws of Darwen. Classic Fusion round all-in-one **tap** with boiling water tank, Cube sparkling and chilled water dispenser, £2,895, Quooker. Claron 180-U undermounted **sink**, £373, Blanco, is a match

### ACCESSORIES

**Blinds** in Holly Pebble linen cotton, £44m, Elanbach. Shoreditch **bar stools**, £390 each, Neptune. Holborn **pendant lights**, from £120.80 each, Jim Lawrence

### EXTENSION DESIGN & BUILD

MVL Architects, Chalmers Property Care and Crumps Carpentry Plus